

STATE WHEN ORDERING

COW = mm
CL = mm
SBL = mm
LAP = mm
G = mm
DW = mm
Door Weight = kg

Surface treatment

☐ Silver anodized
Special anodized
RAL
Special powder coating
.....

	Alt.1	Alt.2	
Overlap (min. 20mm)	LAP	LAP x2 =
Finger protection (min. 25mm)	E	E x2 =
Finger protection (min. 25mm)	-	F x2 =
Jamb width (min. 30mm)	J	J x2 =
Leading edge width	-	P x2 =
Sum of above			Sum =

Alt.1 COW = K	K=	(K + 2LAP) / 2 = DW	DW =
Alt.2 COW + 2P + 2F = K	K=		DW =
Cover length CL	(CL - Sum) / 2 =		= COW max.
Door travel COW	(COW x2) + Sum =		= CL min.

Customer:

Ref:

Door id:

Date:

Project No:

Sign:

Sliding door operator

Besam SL500 SL-B

Art. No. 1009352

ASSA ABLOY

2.0

1013368-EI

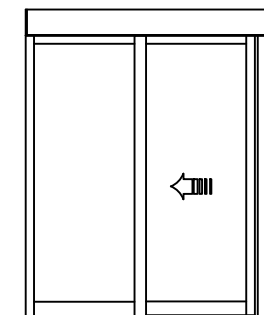
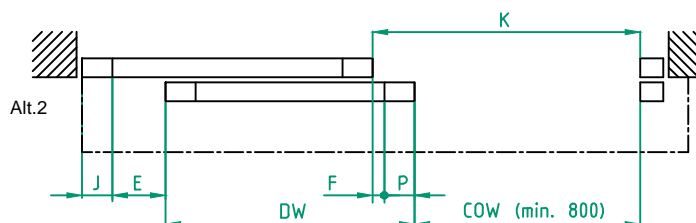
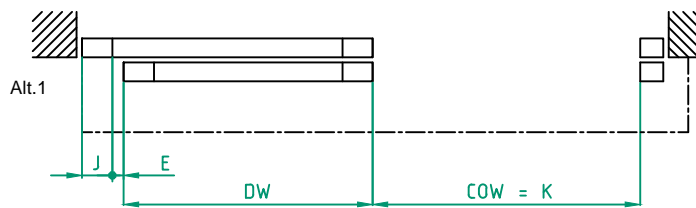
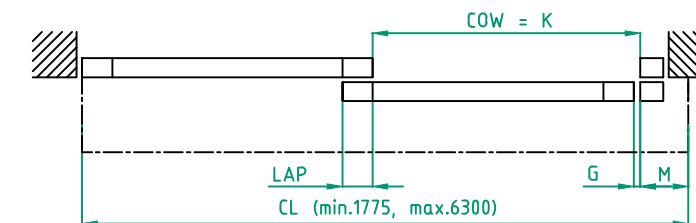
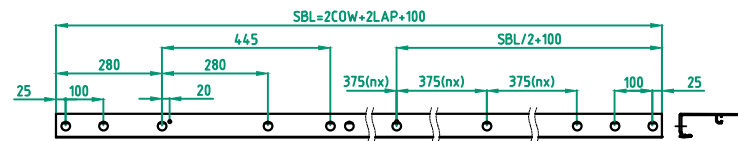
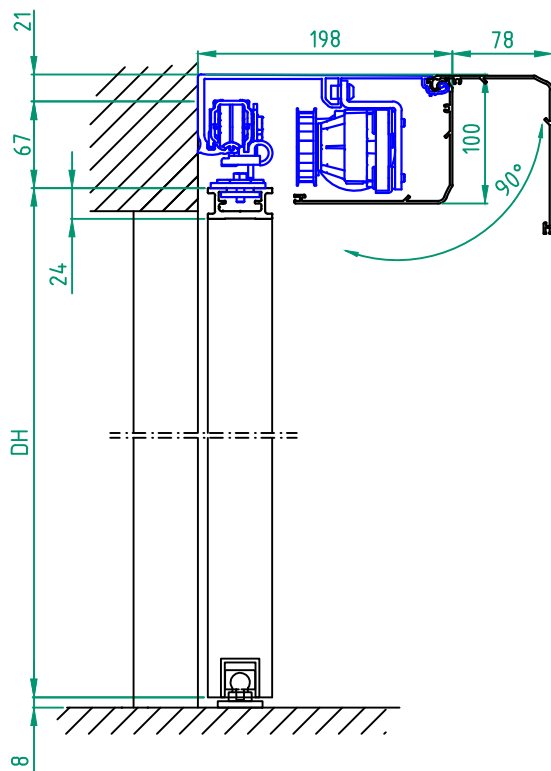

STATE WHEN ORDERING

COW = mm
CL = mm
SBL = mm
LAP = mm
G = mm
DW = mm
Door Weight = kg

Surface treatment

☐ Silver anodized
Special anodized
RAL
Special powder coating
.....

	Alt.1	Alt.2	
Overlap (min. 20mm)	LAP	LAP
Finger protection (min. 25mm)	E	E
Finger protection (min. 25mm)	-	F
Jamb width (min. 30mm)	J	J
Cover overlap (min. 100mm)	M	M
Leading edge width	-	P
Sum of above	Sum =.....		

Alt.1 COW = K K= K + LAP = DW DW =
Alt.2 COW + P + F = K K= K + LAP = DW DW =

Cover length CL (CL - Sum) / 2 = = COW max.
Door travel COW (COW x2) + Sum = = CL min.

Customer:

Ref:

Door id:

Date:

Project No:

Sign:

Sliding door operator
Besam SL500 SL-L

Art. No. 1009352

ASSA ABLOY

2.0

1013368-EI

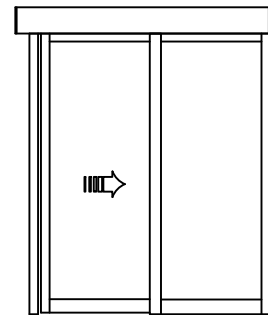
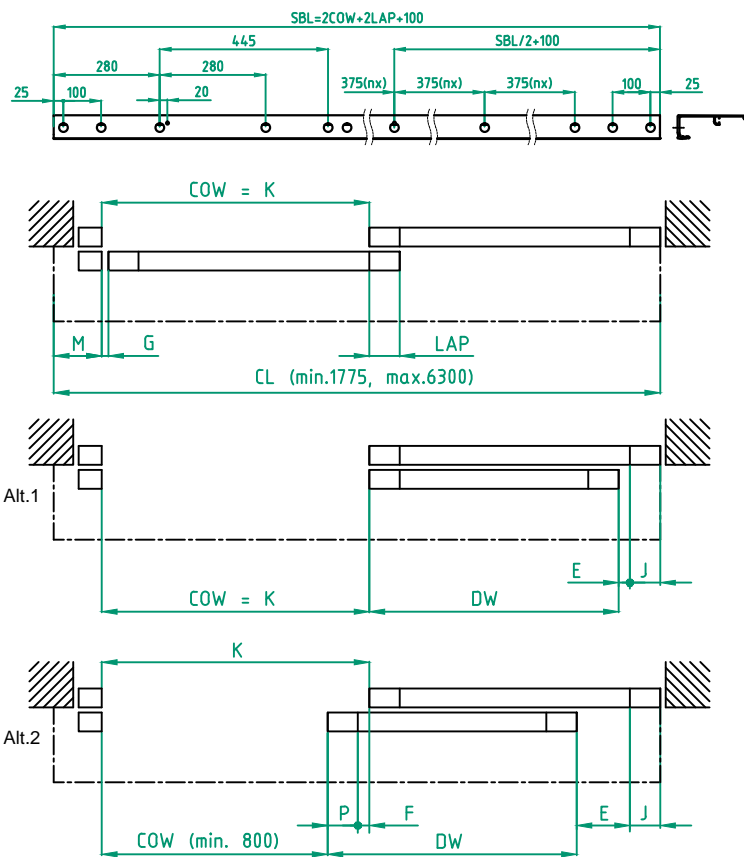
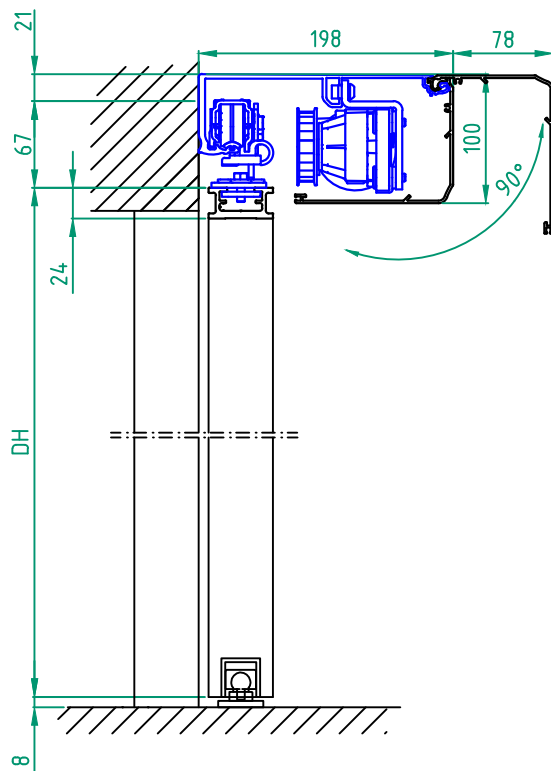

STATE WHEN ORDERING

COW = mm
CL = mm
SBL = mm
LAP = mm
G = mm
DW = mm
Door Weight = kg

Surface treatment

☐ Silver anodized
Special anodized
RAL
Special powder coating
.....

	Alt.1	Alt.2	
Overlap (min. 20mm)	LAP	LAP
Finger protection (min. 25mm)	E	E
Finger protection (min. 25mm)	-	F
Jamb width (min. 30mm)	J	J
Cover overlap (min. 100mm)	M	M
Leading edge width	-	P
Sum of above	Sum =.....		

Alt.1 COW = K K =
Alt.2 COW + P + F = K K = K + LAP = DW DW =

Cover length CL (CL - Sum) / 2 = = COW max.
Door travel COW (COW x2) + Sum = = CL min.

Customer:

Ref:

Door id:

Date:

Project No:

Sign:

Sliding door operator
Besam SL500 SL-R
Art. No. 1009352

ASSA ABLOY

2.0

1013368-EI