

#### STATE WHEN ORDERING

COW = ..... mm  
CL = ..... mm  
SBL = ..... mm  
LAP = ..... mm  
G = ..... mm  
TDW = ..... mm  
Door weight = ..... kg

#### Surface treatment

☐ Silver anodized  
Special anodized .....  
RAL .....  
Special powder coating .....

	Alt. 1	Alt. 2	
Overlap (min. 20mm)	LAP	LAP	..... x2 = .....
Finger protection (min. 25mm)	E	E	..... x2 = .....
Finger protection (min. 25mm)	-	F	..... x4 = .....
Jamb width (min. 30mm)	J	J	..... x2 = .....
Leading edge width	-	P	..... x4 = .....
Sum of above			Sum = .....

Alt.1 COW = K	K = .....	
Alt.2 COW + 4P + 4F = K	K = .....	(K + 4LAP) / 4 = TDW TDW = .....
Cover length CL	(CL ..... - Sum ..... ) / 1,5 = ..... = COW max.	
Door travel COW	(COW ..... x 1,5) + Sum ..... = ..... = CL min.	

Customer:

Ref:

Door id:

Date:

Project No:

Sign:

Sliding door operator

Besam SL500 T-2

Art. No. 1009282

**ASSA ABLOY**

3.0

1010710-EI

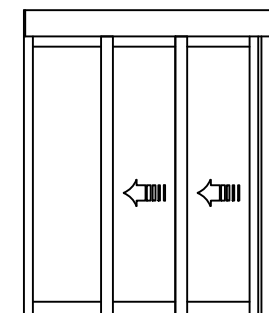
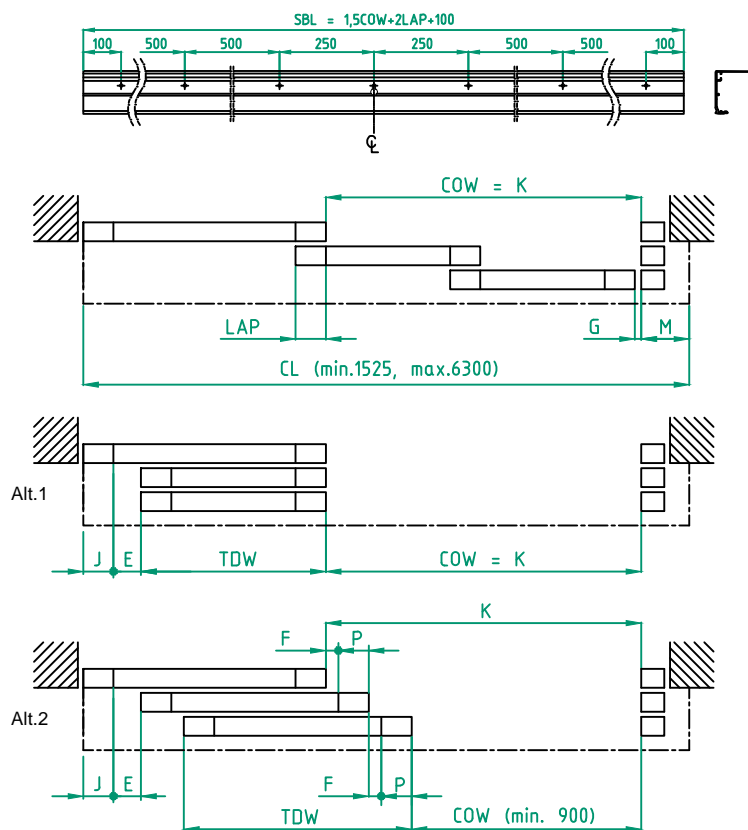
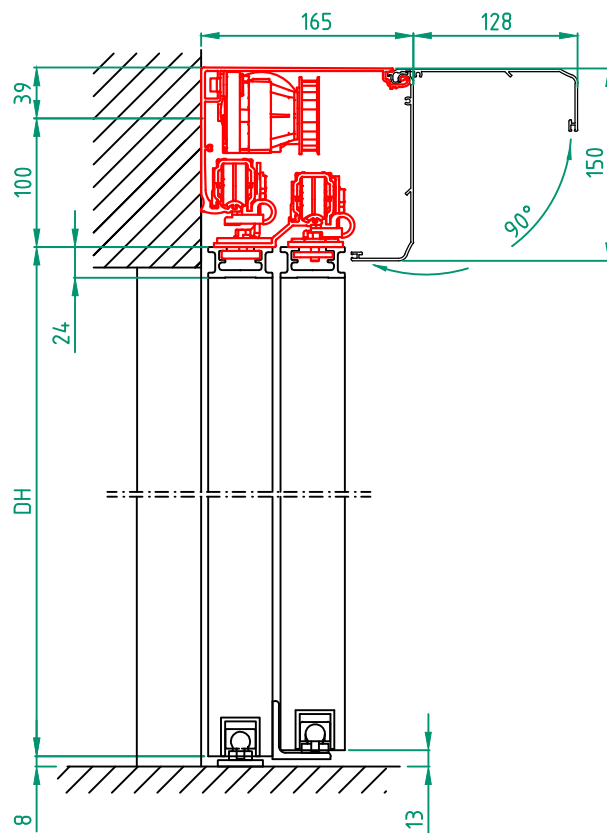

#### STATE WHEN ORDERING

COW = ..... mm  
 CL = ..... mm  
 SBL = ..... mm  
 LAP = ..... mm  
 G = ..... mm  
 TDW = ..... mm  
 Door weight = ..... kg

#### Surface treatment

☐ Silver anodized  
 Special anodized .....  
 RAL .....  
 Special powder coating .....

	Alt.1	Alt.2	
Overlap (min. 20mm)	LAP	LAP	.....
Finger protection (min. 25mm)	E	E	.....
Finger protection (min. 25mm)	-	Fx2=	.....
Jamb width (min. 30mm)	J	J	.....
Cover overlap (min. 100mm)	M	M	.....
Leading edge width	-	Px2=	.....
Sum of above	Sum =.....		

Alt.1 COW = K K= .....  
 Alt.2 COW + 2P + 2F = K K= ..... (K + 2LAP) / 2 = TDW TDW = .....

Cover length CL (CL ..... - Sum ..... ) / 1,5 = ..... = COW max.  
 Door travel COW (COW ..... x 1,5) + Sum ..... = ..... = CL min.

Customer:

Ref:

Door id:

Date:

Project No:

Sign:

Sliding door operator

Besam SL500 T-L

Art. No. 1009282

**ASSA ABLOY**

3.0

1010710-EI

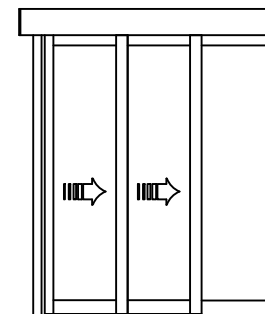
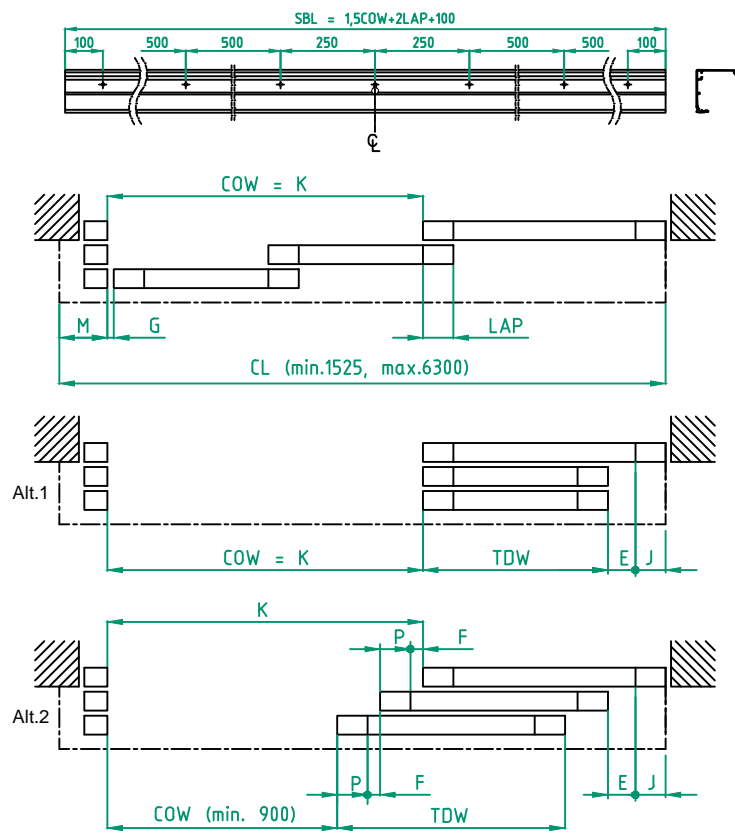
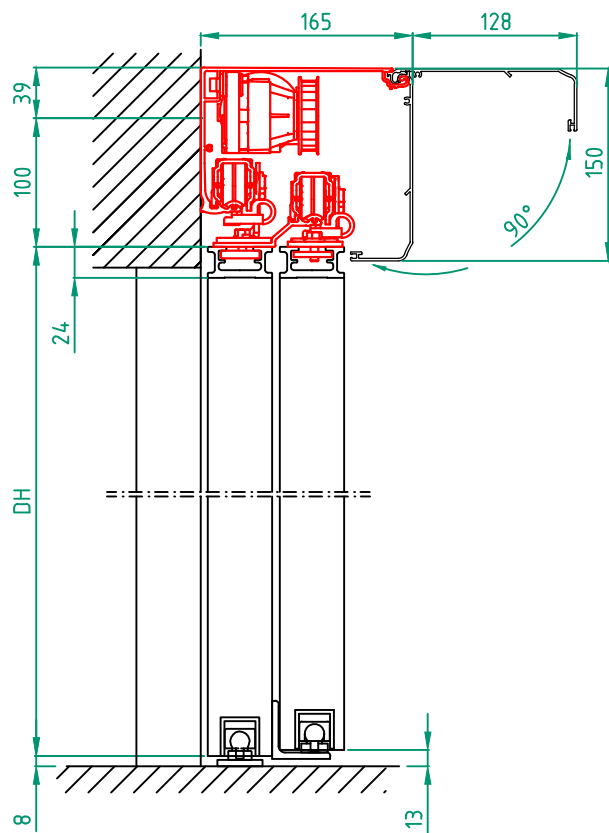

#### STATE WHEN ORDERING

COW = ..... mm  
 CL = ..... mm  
 SBL = ..... mm  
 LAP = ..... mm  
 G = ..... mm  
 TDW = ..... mm  
 Door weight = ..... kg

#### Surface treatment

☐ Silver anodized  
 Special anodized .....  
 RAL .....  
 Special powder coating .....

	Alt.1	Alt.2	
Overlap (min. 20mm)	LAP	LAP	.....
Finger protection (min. 25mm)	E	E	.....
Finger protection (min. 25mm)	-	Fx2=	.....
Jamb width (min. 30mm)	J	J	.....
Cover overlap (min. 100mm)	M	M	.....
Leading edge width	-	Px2=	.....
Sum of above	Sum =.....		

Alt.1 COW = K K= .....  
 Alt.2 COW + 2P + 2F = K K= ..... (K + 2LAP) / 2 = TDW TDW = .....

Cover length CL (CL ..... - Sum ..... ) / 1,5 = ..... = COW max.  
 Door travel COW (COW ..... x 1,5) + Sum ..... = ..... = CL min.

Customer:

Ref:

Door id:

Date:

Project No:

Sign:

Sliding door operator  
 Besam SL500 T-R  
 Art. No. 1009282

**ASSA ABLOY**

3.0

1010710-EI